

Offices for Lease



2220 W 18th Street
Port Angeles, WA



1,880 SF @ \$1.00/SF
438 SF shared reception @
\$0.50/SF
Plus leasehold excise tax
Total Rent/month **\$2,368.51**

- Open Classroom Space
- 3 Manager Offices
- Located in industrial park
- Free open parking
- Close to William Fairchild Int'l Airport



Contact:

☎ 360-417-3435

✉ cherieg@portofpa.com

🌐 www.portofpa.com



2220 W 18th St

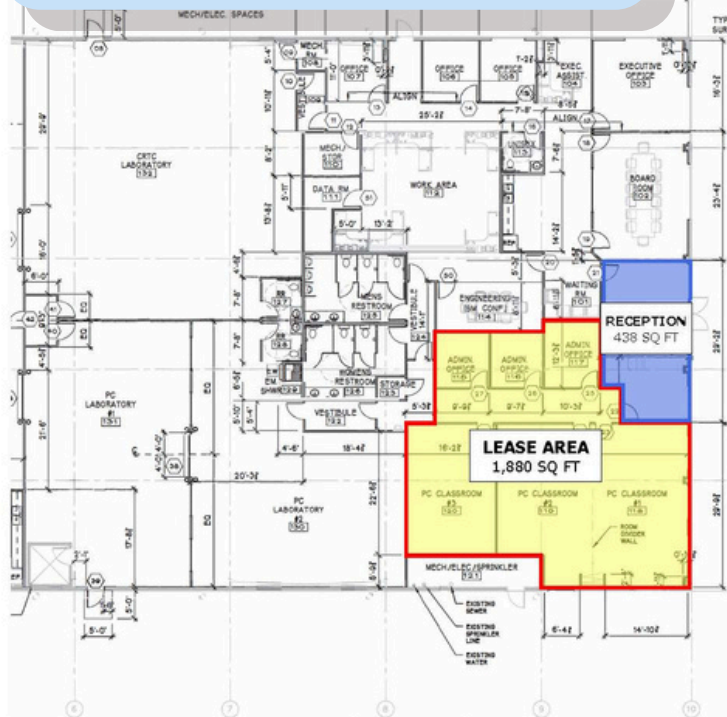

EXHIBIT A1: LEASE AREA

DATE:
1/20/2025

SHEET:
1 OF 1

LESSEE:
LOCATION: 2220 W 18TH ST, PORT ANGELES, WA

SCALE:
1" = 20'



N. Airport Industrial Park
18th Street, Port Angeles, WA

Legend
 2220 W 18th St
 KCLM WILLIAM R FAIRCHILD INTL